



CORNER INVESTIGATION REPORT

FS INDEX ID: R-21

CORNER: SECTION GCDB ID: 600300 **DATE:** 6/11/2018
TOWNSHIP: 3S **STATE:** OREGON
RANGE: 8W **COUNTY:** TILLAMOOK
SECTION: 23, 24, 25 & 26 **FOREST:** SIUSLAW
MERIDIAN: WILLAMETTE **DISTRICT:** HEBO
NFSL PROPERTY BOUNDARY CORNER?: YES NO
LINE(S) POSTED: SOUTH - NONE WEST - 2017
MAINTAINED:
GUARD POST(S): SOUTH - 2.5 FT S86°W ~ 100 FT

HISTORY OF VISITATIONS:

- (1)1884 - H. MELDRUM, GLO SURVEY
- (2)1962 - L.M. ROSEBERRY, BLM RESURVEY, RW1-PG497 & 499
- (3)1965 - B. UDELL, CSF# A-1237
- (4)1973 - UNKNOWN SURVEYOR, BLM UNRECORDED ADMIN SURVEY.
- (5)1980 - F. JOHNSON, USFS RECORD
- (6)1985 - L. BISHOP, CSF# B-1195

CORNER HISTORY:

- (1) ESTABLISHED CORNER, SET 16"x12"x10" BASALT STONE & 4 BT'S.
- (2) FOUND STONE & 4 BT'S, SET IRON PIPE/BRASS CAP & 3 NEW BT'S.
- (3) FOUND "BRASS CAP (B.P.L.S.)" WITH NO NOTE OF BT'S PRESENT.
- (4) PER NOTE ON (5) BLM TILLAMOOK OFFICE RETRACED SECTION LINE SOUTH FROM THIS CORNER. RECORD REQUESTED FROM BLM BUT NONE FOUND.
- (5) FOUND IRON PIPE/BRASS CAP & 7 BT'S.
- (6) FOUND IRON PIPE/BRASS CAP & 7 BT'S, MARKED 2 NEW BT'S.

MONUMENT FOUND/SET:

FOUND A 2-1/2" GALVANIZED IRON PIPE WITH A 3-1/4" BRASS CAP, PROJECTING 6" ABOVE THE GROUND.

RECORD CORNER ACCESSORIES:

- A ROTTED FIR STUMP BEARS, N49°W - 9.9 FT, WITH NO MARKS VISIBLE.
- A ROTTED FIR STUMP BEARS, N62°E - 17.0 FT, WITH NO MARKS VISIBLE.
- A ROTTED FIR STUMP BEARS, S14°24'E - 39.1 FT, WITH NO MARKS VISIBLE.
- A ROTTED FIR STUMP BEARS, S57°27'W - 23.5 FT, WITH NO MARKS VISIBLE.
- A 54" ROTTED FIR STUMP BEARS, N54°11'E - 94.7 FT, WITH SCRIBE FRAGMENTS VISIBLE.
- A 41" FIR BEARS, S18°57'E - 77.0 FT, WITH A HEALED SINGLE BLAZE.
- A ROOT HOLE BEARS, S15°41'W - 83.3 FT, 19" FIR LOG LAYS NORTH ON FACE.
- A 14" ALDER BEARS, N34°12'W - 25.5 FT, WITH BARK SCRIBES VISIBLE.
- A 35" FORKED HEMLOCK BEARS, S74°18'W - 35.4 FT, WITH FACE OBSTRUCTED.

NEW CORNER ACCESSORIES:

- A 16" ALDER BEARS, N78°11'E - 25.4 FT, BARKED SCRIBED "T3SR8WS24BT".
- NEW BT'S INCLUDE A 3/4" BRASS WASHER NAILED BETWEEN "B" & "T" SCRIBES.

CORNER MAINTENANCE/OTHER INFO:

CLEAR BRUSH FROM AROUND MONUMENT & TO BT'S, BT FACES & A 6" BAND AT HEAD HEIGHT PAINTED RED. ADD NEW NAILS TO BT TAGS & ADD NEW TAGS WHERE NEEDED. MONUMENT SIZES ARE OUTSIDE DIAMETER & BT DIAMETERS ARE AT BREAST HEIGHT.

NFSL LINES BEAR: S85°56'24"W - 1335.02 FT & (6)S1°03'56"E - 1263.60 FT

GEODETIC COORDINATES:

LATITUDE: N 45° 17' 15.92104"
 LONGITUDE: W 123° 37' 36.99306"
 ELLIPSOID HEIGHT: ~1560 FT
 DATUM: NAD83(2011) EPOCH:2010

DOCUMENTS ON FILE AT:

WILLAMETTE NATIONAL FOREST
 3106 PIERCE PARKWAY, STE D
 SPRINGFIELD, OREGON 97477

SOURCE: LEAST SQUARES ADJUSTED TRAVERSE TIED TO GEODETIC CONTROL.

DATE OF INVESTIGATION: 12/05/2017

REPORT BY: JONATHAN B. DREW II, PLS#89396, CFedS#1664

FIELD CREW: ANDREW HILLMAN, USFS SURVEY TECH.
 JACOB HUNT, USFS SURVEY TECH.
 JAMES CROUSE, USFS SURVEY TECH.

THIS DOCUMENT FILED IN CS OFFICE: YES

OTHER DOCUMENT FILED WITH CS: RECORD OF SURVEY FILED SEPARATELY

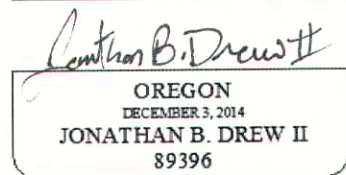
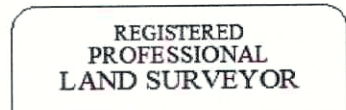

- EXPIRES: 12/31/2019
- RECORD MEASUREMENTS:**
- (1,2,5)N49°W - 9.24 FT
 - (1,2,5)N63°E - 14.52 FT, (6)14.5 FT
 - (1)S18°E - 36.96 FT, (2,5)S13°E, (6)S13°E - 37.1 FT
 - (1,2,5,6)S49°W - 21.12 FT
 - (2,5)N56°E - 94.38 FT, (6)28.4 FT
 - (2,5)S17°E - 77.88 FT, (6)77.9 FT
 - (2,5)S16°W - 86.46 FT, (6)86.5 FT
 - (6)N32°W - 24.4 FT
 - (6)S76°W - 35.7 FT

METHOD OF MEASUREMENT:
 TRIMBLE S7 TOTAL STATION & TRIMBLE R8-3 RTK GPS SYSTEM. TRAVERSE CLOSED ON GEODETIC CONTROL. SEE RECORD OF SURVEY FOR MORE INFO. BT DISTANCE TO ALUMINUM NAIL SET SIDE CENTER, BEARINGS TO CENTER. ALL BEARINGS ARE MEAN GEODETIC & DISTANCES ARE AT GROUND.

CAP DIAGRAM:

